



A Modular Pump That Will Grow With You

MP SERIES PUMPS

Accent manure pumps are manufactured with stainless steel to keep them corrosion free, provide greater wear resistance and give them a longer life cycle. Engineered components including cast volute cases and finely machined rotating parts provide superior flow characteristics and improved power efficiencies. Accent pumps will lower your operating costs and last longer.

SUPERIOR STAINLESS STEEL CONSTRUCTION

Farm operators understand the benefits of quality material because their equipment has to keep working, often in harsh or abrasive conditions. At Accent we understand those conditions and manufacture our pumps to exacting standards using only the highest quality steel material available - 304 and hardened 440C stainless.

SIMPLE. VERSATILE. DURABLE.

Accent pumps are designed for **Simplicity** so you get trouble free operation. They incorporate upgradeable components and engineering **Versatility** that ensures your pump won't become obsolete. When you buy an Accent pump you get high quality interchangeable components like oil bath drive shafts, silicon carbide mechanical seals, extra heavy castings, important features that ensure **Durability** and long equipment life.

www.accentmanufacturing.com



Accent Manufacturing Inc.
602 - 30731 Simpson Road, Abbotsford, British Columbia, Canada V2T 6Y7. Tel: 604.850.7799. Fax: 604.850.7909.
E-mail: info@accentmanufacturing.com

Accent MP Series Pump

A RUGGED PUMP WITH GROWTH OPTIONS

The Accent MP Series Manure Pump provides many features and benefits. This rugged pit pump is constructed in stainless steel to keep your system running trouble-free for years. Its modular design uses interchangeable components that transform your pump's capabilities to meet your expanding needs. It's another engineered product from Accent, the first choice for manure separation equipment around the world.

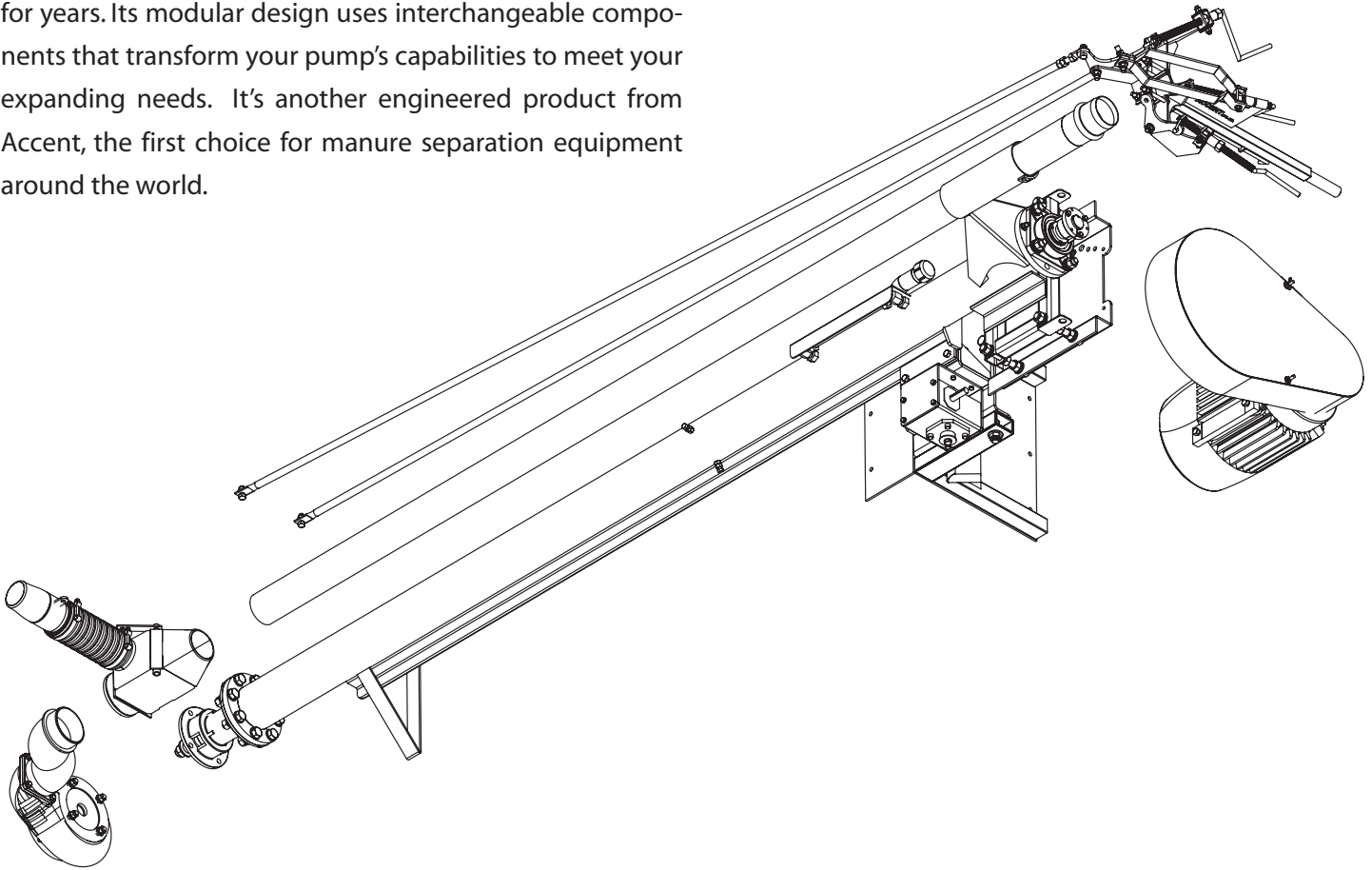

Features	Benefits
■ All Stainless Steel Construction	■ Non corrosive provides long life
■ Modular Design	■ Completely Upgradeable, never becomes obsolete
■ Extra Heavy Cast Volute	■ Provides greater wear resistance for longer life
■ 440C Hardened Impellor	■ Provides greater wear resistance for longer life
■ Mechanical Seal	■ Maintenance Free, positive sealing